

Xander

COMPUTER CASE

USER MANUAL

1. Specifications
2. Chassis Parts
3. Control Panel Functions
4. 3.5"/2.5" HDD/SSD Installation
5. Remove the left glass side panel
6. Remove the right metal side panel
7. Remove the Front panel
8. From top to bottom, fasten the panel to chassis
9. Cooling System Installation
10. Master Fan & Sub-fan Installation
11. Fan Installation
12. RGB Lighting Switching

Specifications

Model	
Model Name:	Xander
Model Number:	CSAZ-150
Specifications	
Type:	Micro ATX Mid Tower
Color:	Black/Black(interior)
Side Panel Window:	Left side panel: slidable tempered glass panel
Max CPU Cooler Height:	UP to 175mm
Max Video Card Length:	Up to 340mm long video card
Power Supply:	Not included
Motherboard Compatibility:	Micro ATX · ITX
Expansion	
External 5.25" Drive Bays:	0
Internal 2.5" Drive Bays:	Up to 4
Internal 3.5" Drive Bays:	Up to 2
Expansion Slots:	4
Top Ports:	Power button, LED button, HD Audio, USB 3.0 x 2
Physical Specifications	410x220x381 / 16.1x8.7x15 inches
Weight:	5.6kg /12.3lbs
Features	
Tempered Glass Sides Window:	High-quality tempered glass side window allows for clear visuals to inner components
Addressable RGB Light Effects:	All ARGB light sync. devices connected to the ARGB control board, allowing the LED button or switch to the motherboard software to directly control the ARGB lighting.
Available Fan Ports:	3x120mm or 2x140mm Fan ports in the front(2x120mm LFO-4412D ARGB fan included) 3x120mm or 2x140mm Fan ports on the top 1x120mm Fan port in the rear(1x120mm LFO-4412D ARGB fan included)
Water Cooling:	Supports radiators up to 240/280mm on the top Supports radiators up to 240/280mm in the front
Dust Filters:	Removable (magnetic) dustproof net on the top and front, dust filter on bottom of chassis.
Power Supply Support:	Bottom mounted ATX Power Supply

※ PWM Fan: The model comes with PWM fans and will run at top speed unless connected to a motherboard or controller.

Chassis Parts

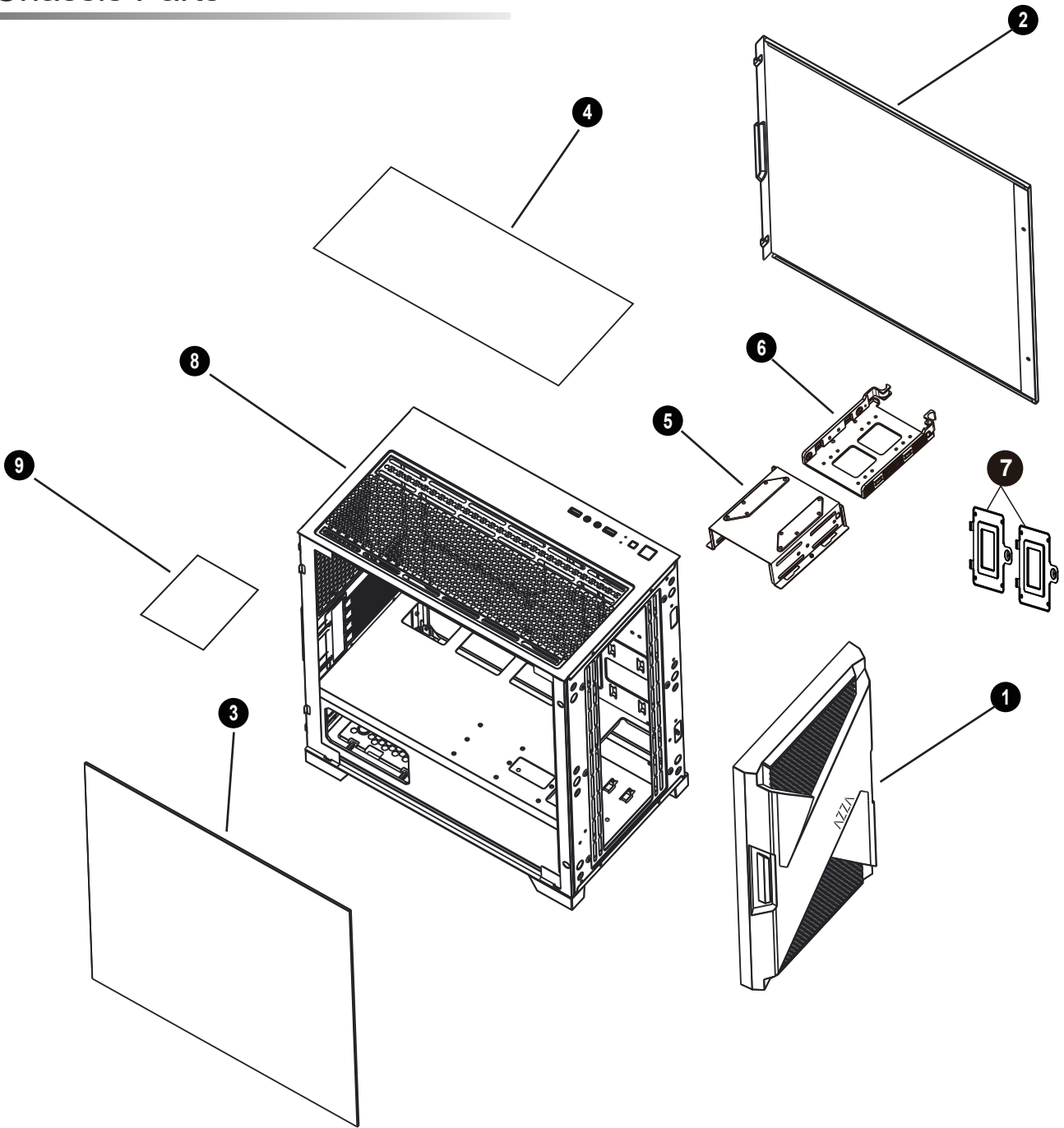

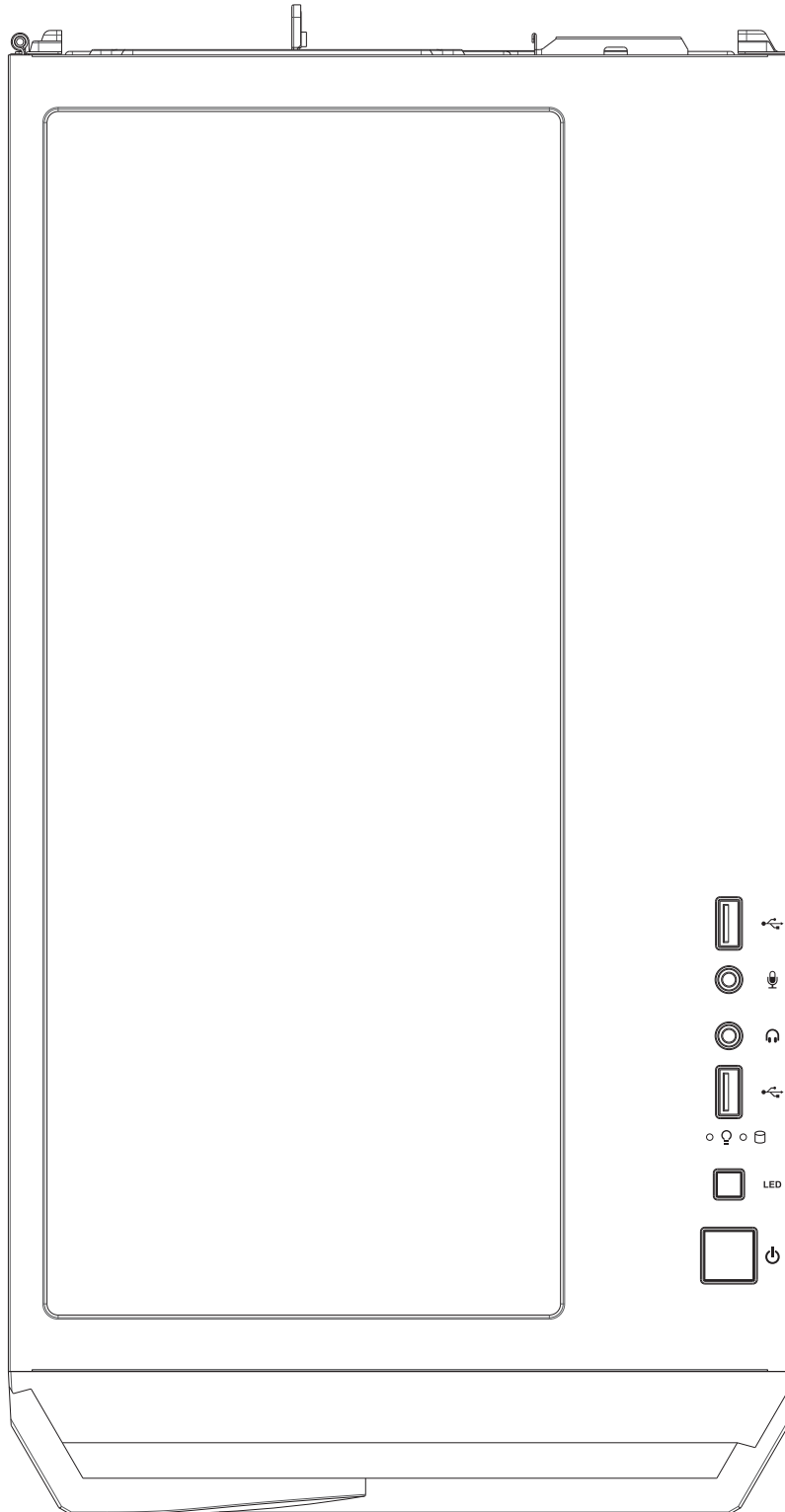

1	Front panel
2	Metal side panel
3	Tempered glass panel
4	Removable magnetic mesh
5	Hard disk cage
6	3.5" HDD/ 2.5" SSD brackets
7	2.5" SSD tray x 2
8	Chassis
9	Dust filter mesh

Control Panel Functions



	POWER
	LED
	Mic
	Audio

	USB 3.0
	USB 3.0

3.5" / 2.5" HDD/SSD Installation

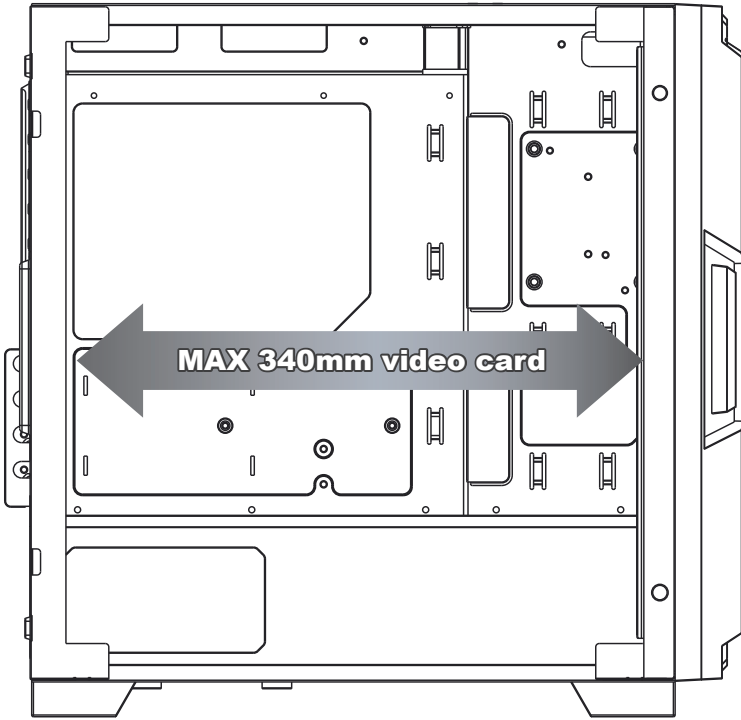

- Supports up to 390mm long video cards.



or

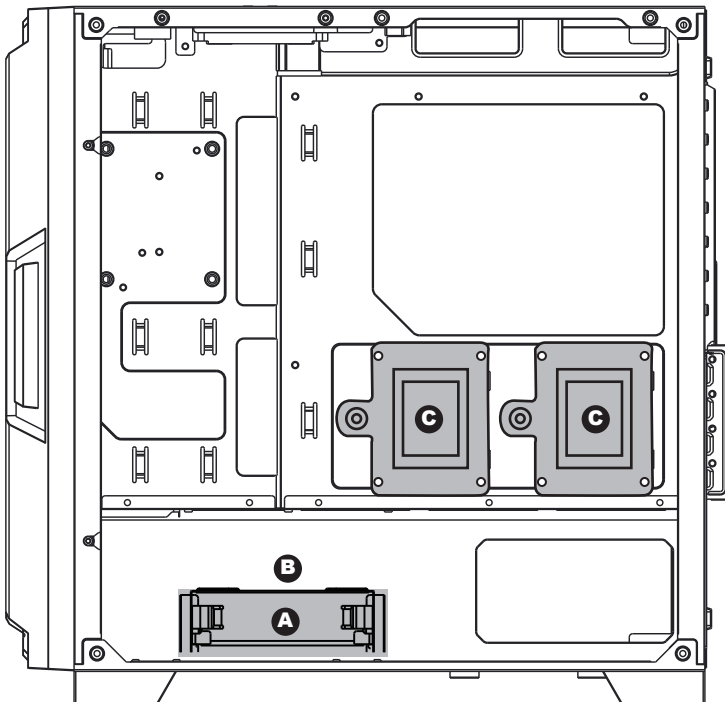
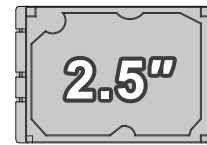

- Multifunctional hard disk bracket support
3.5" HDD or 2.5" SSD x 1 (**A**)
- 2.5" SSD metal tray support 2.5" SSD x 2
(**C**)
- Multifunctional hard disk cage support
3.5" HDD or 2.5" SSD x 1 (**B**)

Remove the left glass side panel

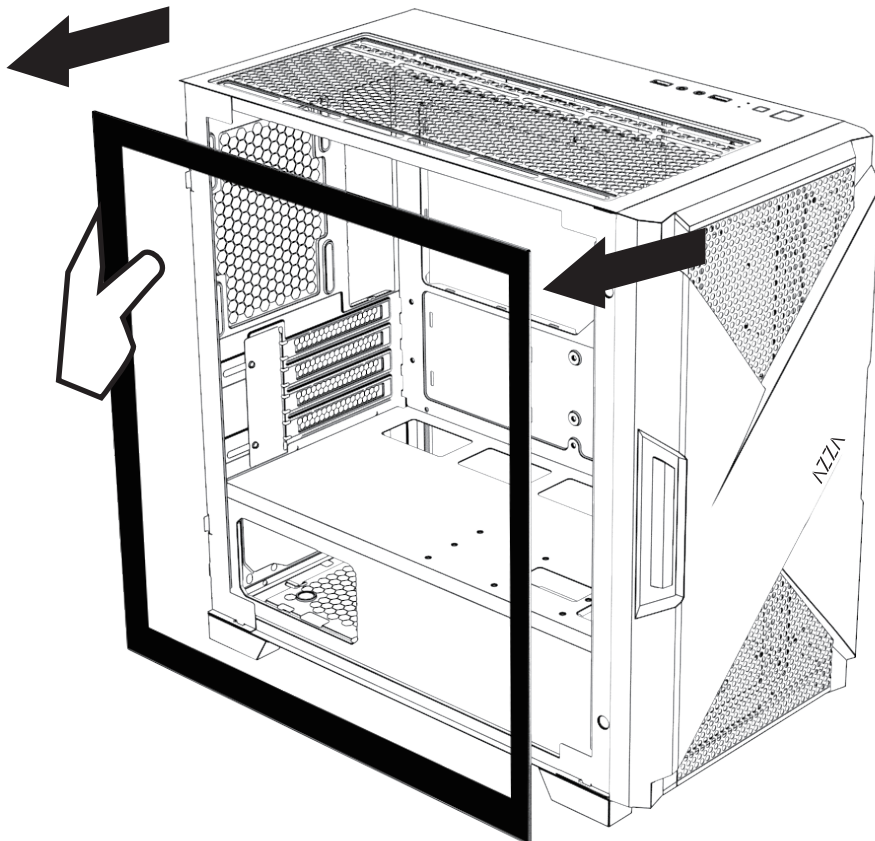
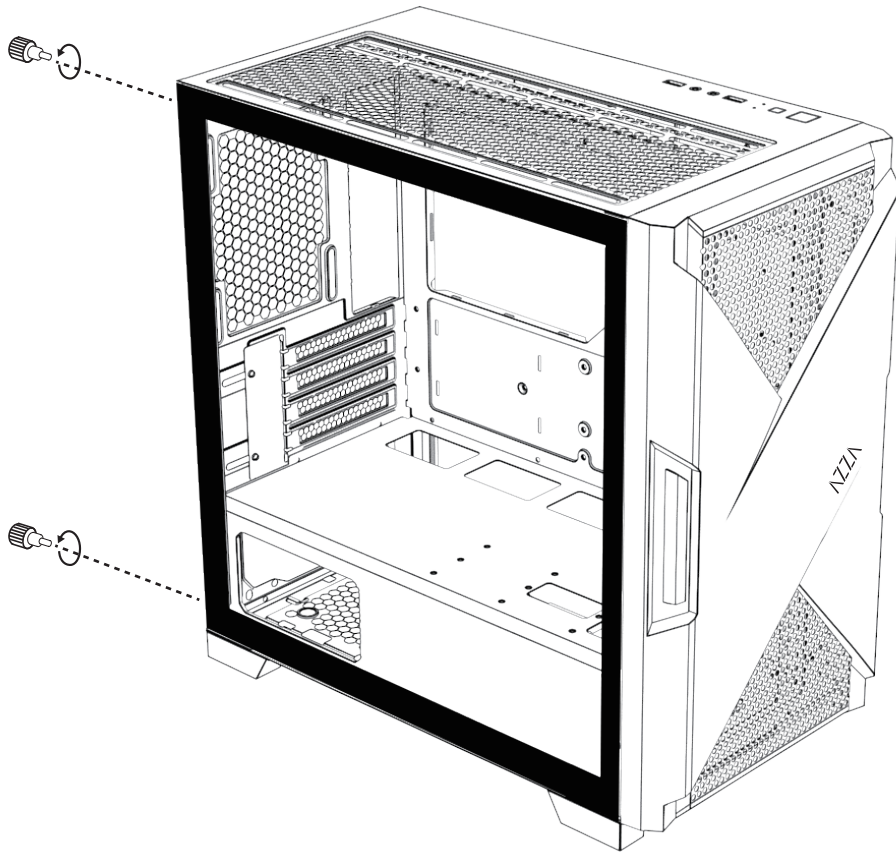

Remove the right metal side panel

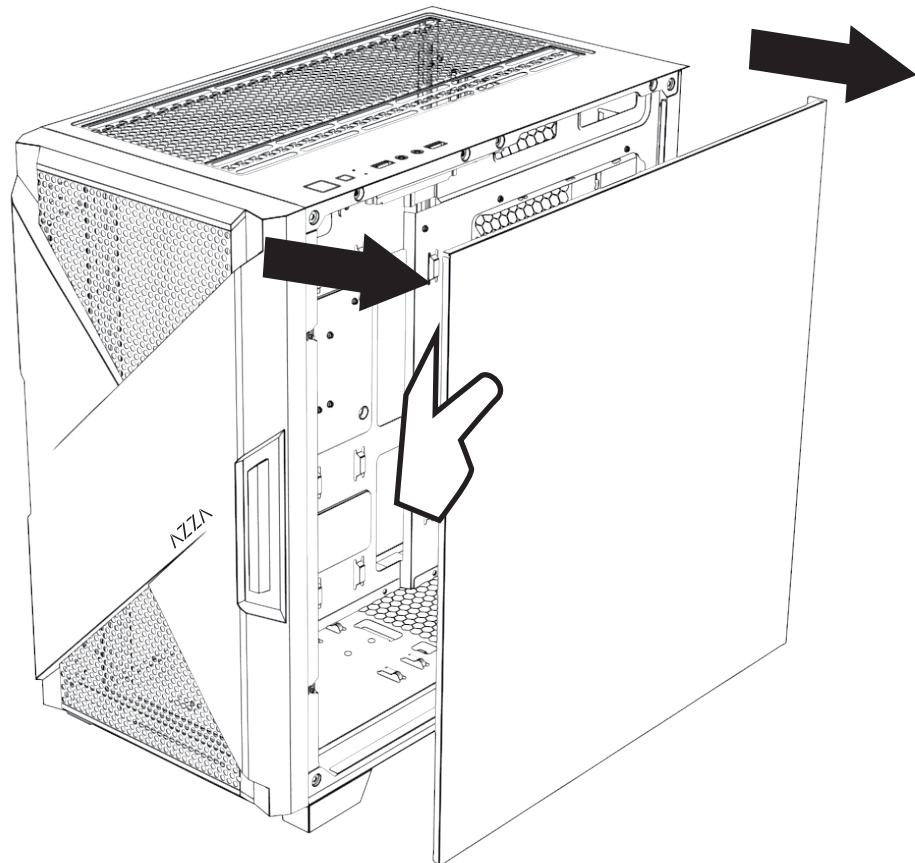
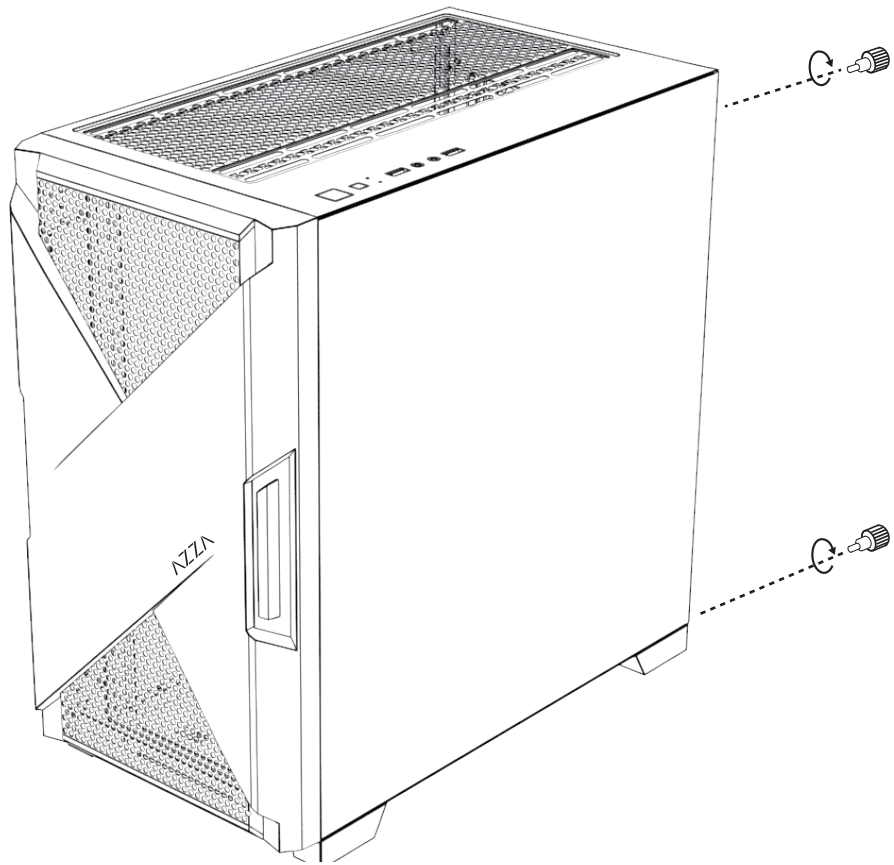

Remove the Front panel

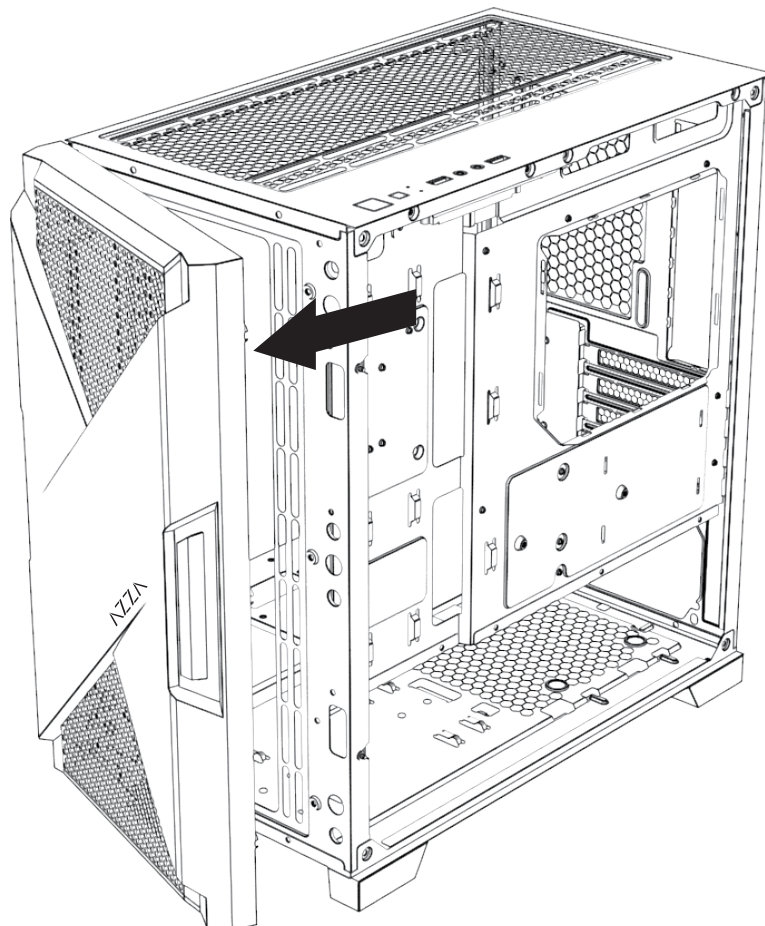
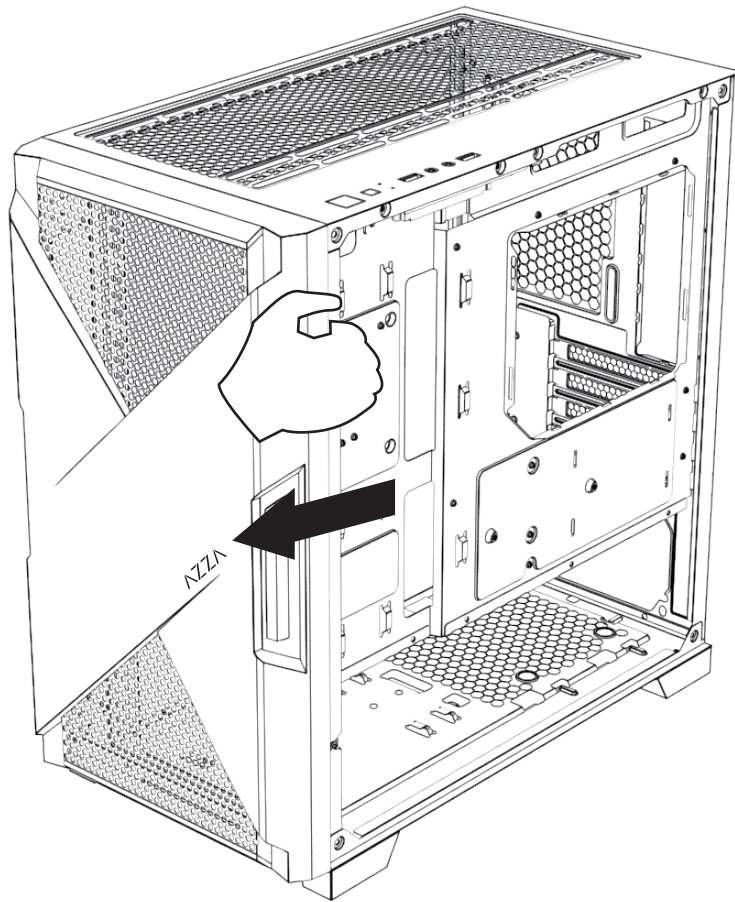

From top to bottom, fasten the panel to chassis

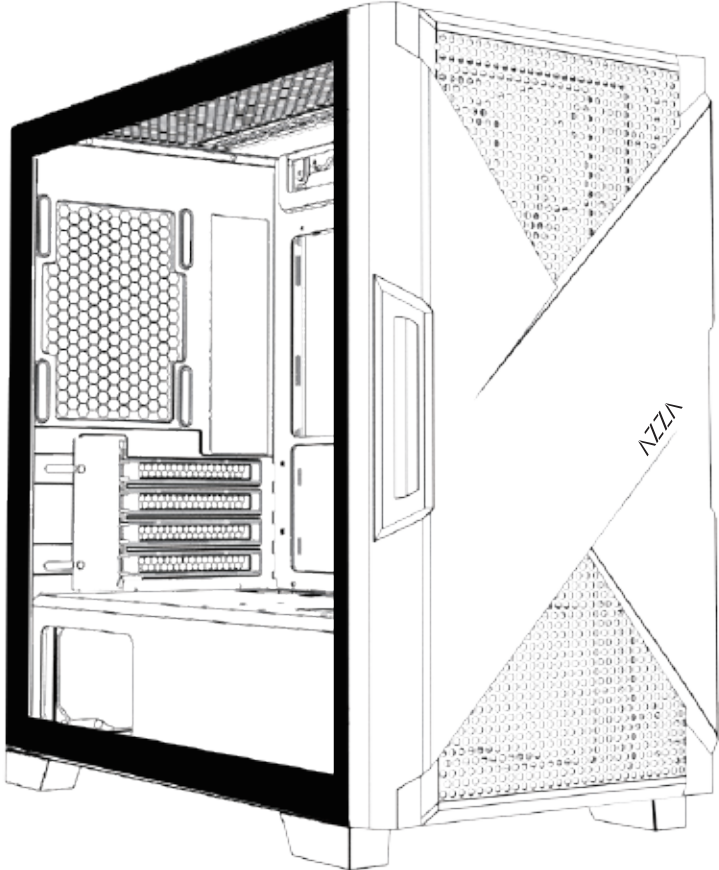
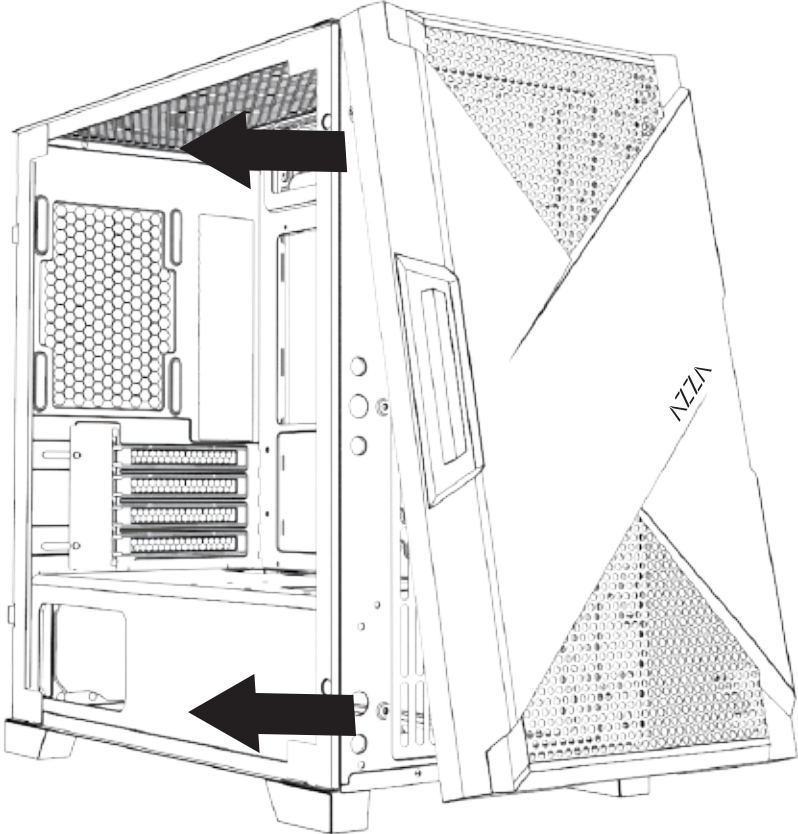

Front

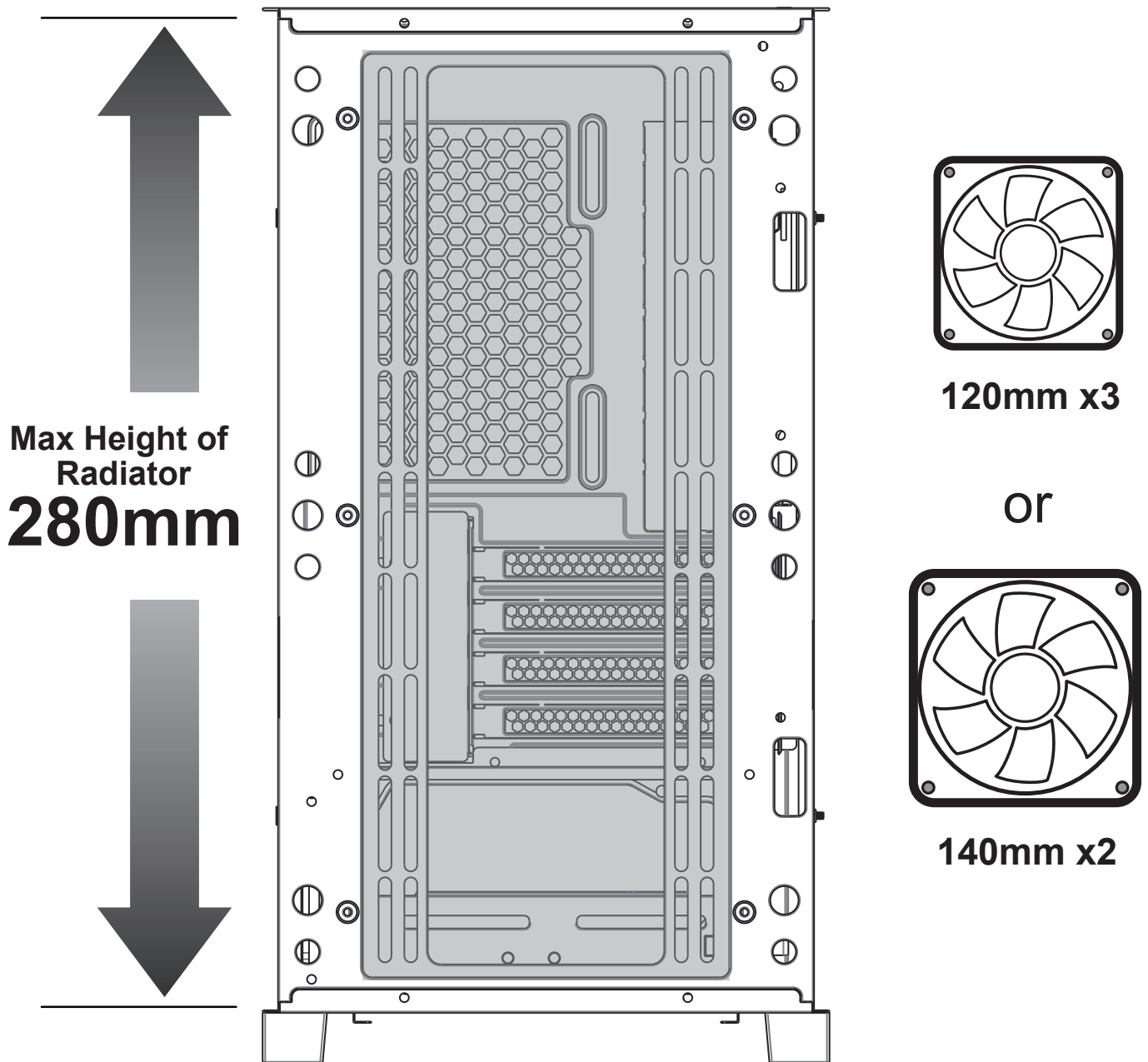

Rear

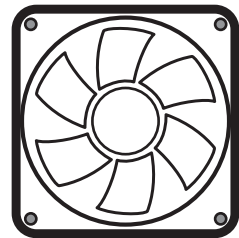
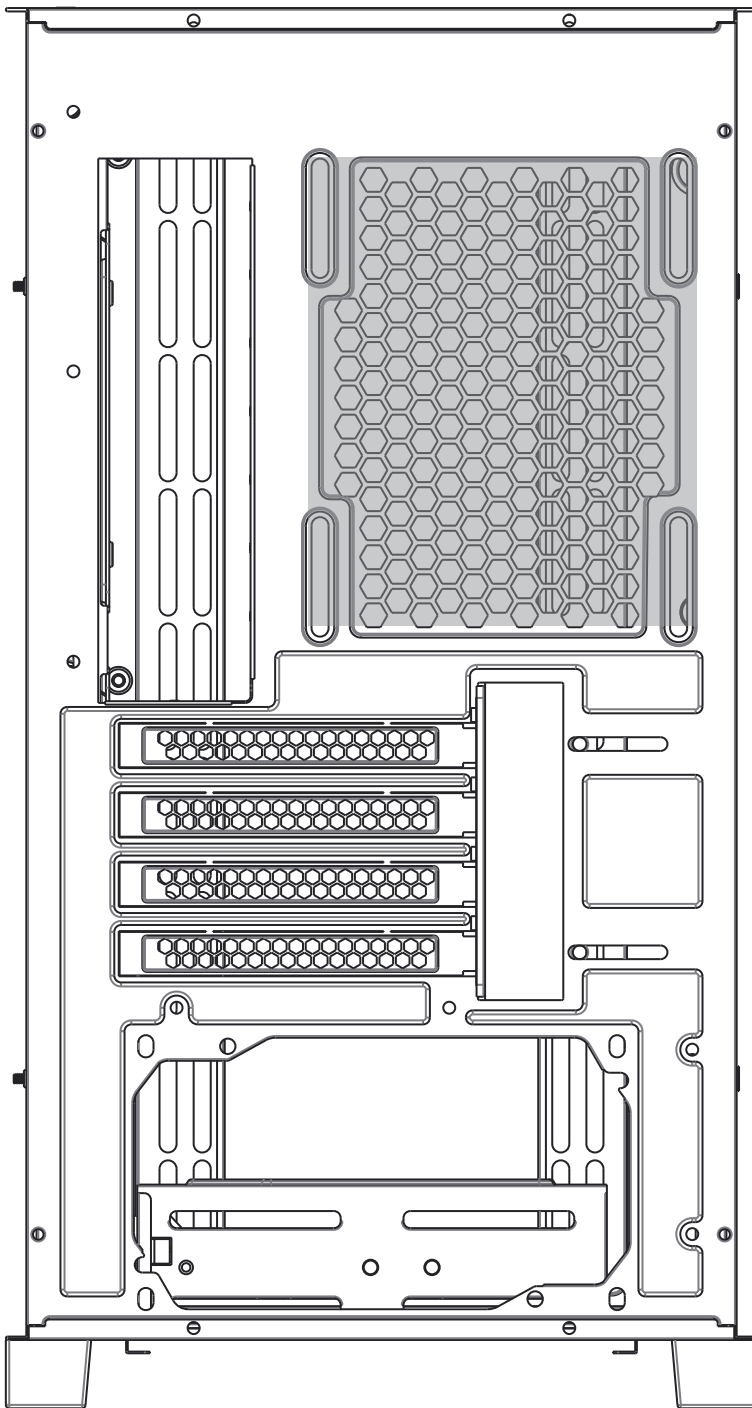

120mm x1

Top

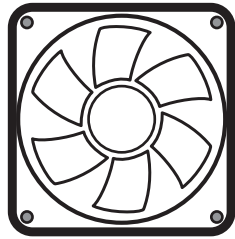

120mm x3

or

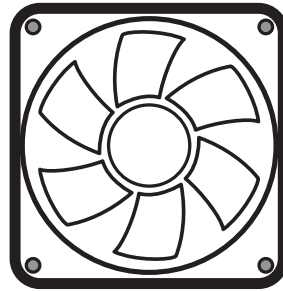

140mm x2

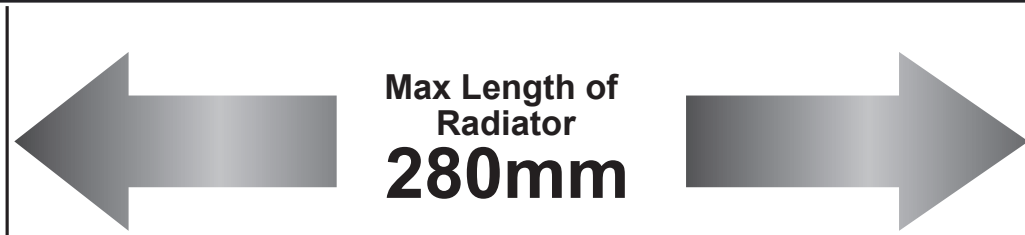
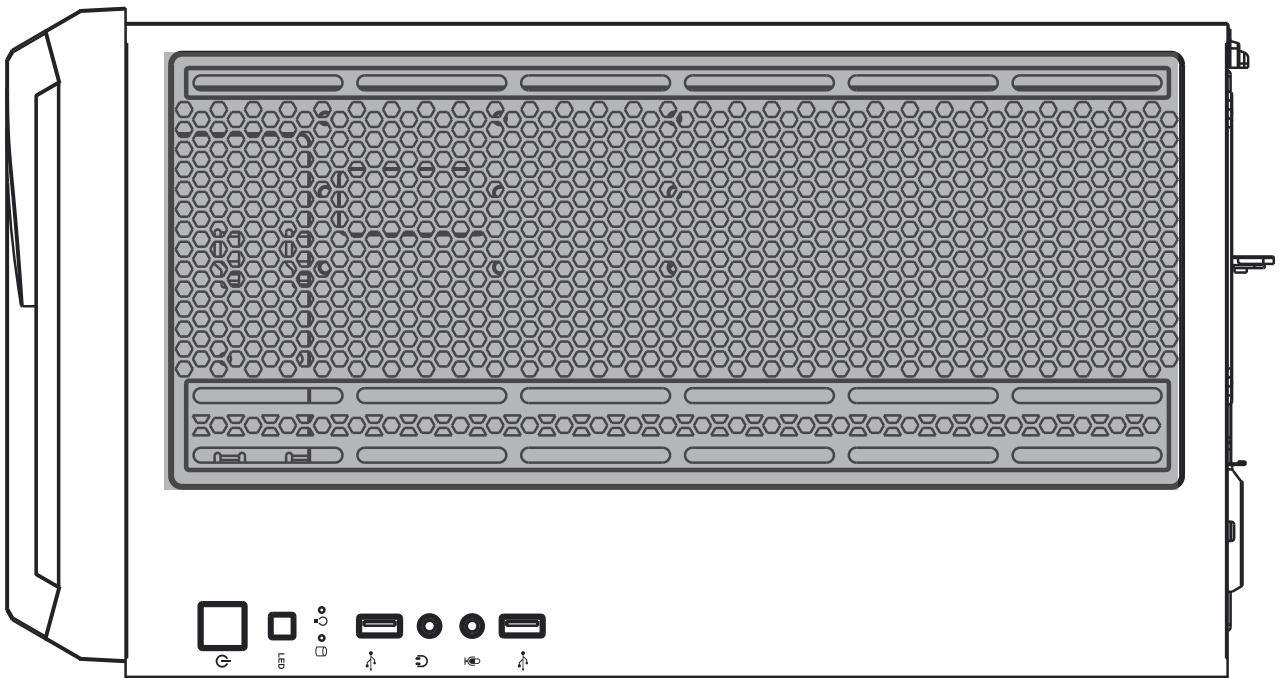

Master Fan & Sub-fan Installation

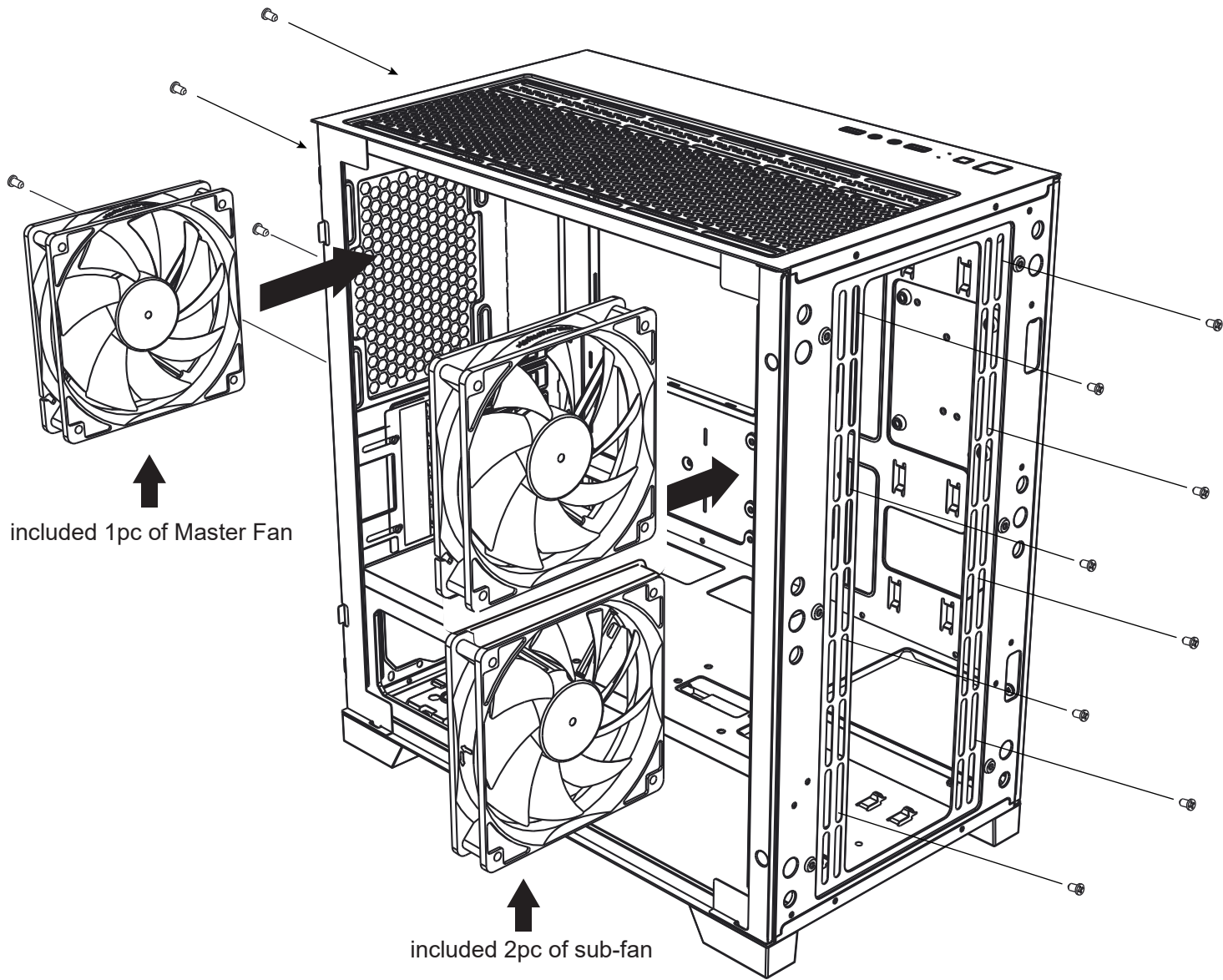

Fan Installation

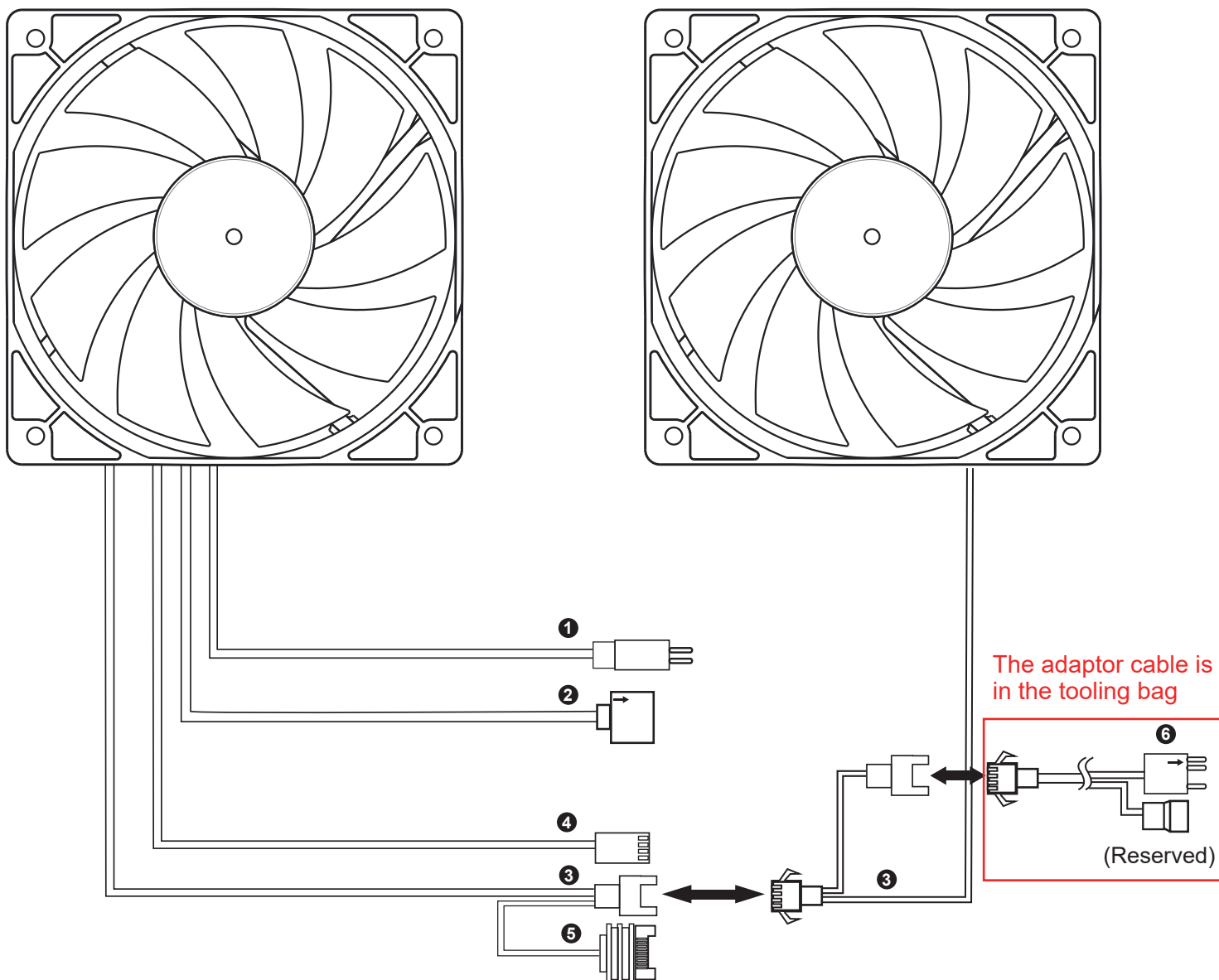

	CONNECTOR	CONNECTION
①	Reset (LED) S/W (2pin)	LED Button
②	ARGB LED 5V (3pin) female connector	The 5V/3pin ARGB socket of the motherboard
③	Fan Connector	The master Fan connect to the sub-fan
④	Fan Connector PWM (4pin)	CHA_FANx socket of the motherboard
⑤	SATA	Power Supply
⑥	ARGB LED 5V (3pin) male connector	Other 5V/3pin ARGB devices

※ Before the fan starts, please make sure the PWM connector ④ and SATA connector ⑤ each are connected.

※ Press the LED button to cycle through different RGB lighting modes, all ARGB devices are controlled by the LED button. (make sure the other 3pin ARGB devices are connected with ⑥)

※ Ensure ② insert the motherboard, and hold the LED button for 3 seconds to switch the RGB control function to the motherboard RGB sync. software. Press 1 second LED button, and switch the RGB control function to the LED button.

RGB Lighting Switching

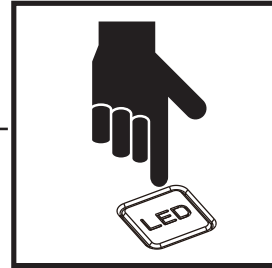

- Press the LED button to cycle through different RGB lighting modes.

