

HURRICANE RGB LITE



USER MANUAL

HURRICANE RGB LITE

Patented Design

VORTEX AIR (Patented)

To help improve cooling performance, our patented Shark Teeth design helps channel the air into a concentrated stream for more powerful air flow.

SILENCE (Patented)

Special grooves carved into the fan blades help reduce noise levels up to ten percent!

SYNC RGB (Patented)

By plugging the Hurricane RGB fan into a RGB-compatible motherboard, lighting and fan speed can be controlled directly without the need for additional hardware.

CYLINDRICAL LIGHTNING (Patented)

More light is better. With a frame made of acrylic material, the RGB lighting is spread all throughout the fan's frame, giving a clean, uniform look.

Model Name	HURRICANE RGB LITE
	HURRICANE RGB LITE+RF REMOTE
Model Number	FNAZ-12RGB-B-002/232
	FNAZ-12RGB-W-002/232
Rated Voltage	12V
Fan Speed	1500 RPM
Max. Air Pressure	1.26 mm-H ₂ O
Max. Air Flow	47CFM
Max. Noise Level	28.7dB(A)
Bearing Type	Sleeve Bearing
Life expectation	60,000 hrs,40°C
Connector	3-PIN
	4-PIN RGB: Male & Female
Fan Dimension	120x120x25mm
Color	7 Color with RF remote
	16.8M with LUMI

EXTERNAL VIEW

Front

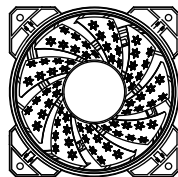

Back

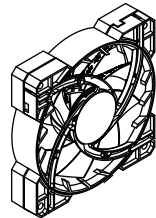
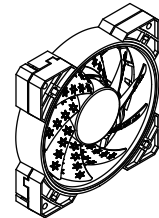
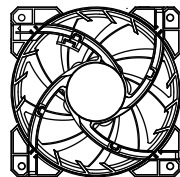

PARALLEL CONNECTION

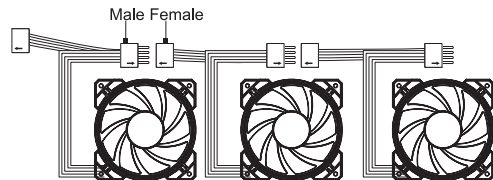



INSTALLATION

•If you have a RGB-compatible motherboard, then you can connect the Hurricane fan's 4-pin connector directly into your motherboard. You can then adjust fan colors using your native fan control software.

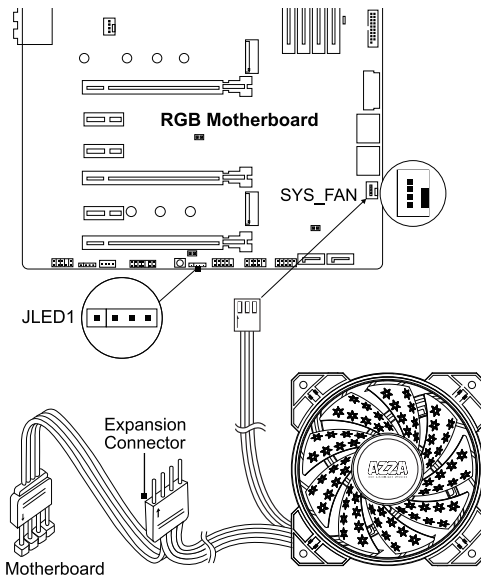

•If you have our RF remote, then you can connect the 4-pin cable from the fan directly into the RF IC instead. You can then control fan colors using the RF remote controller.

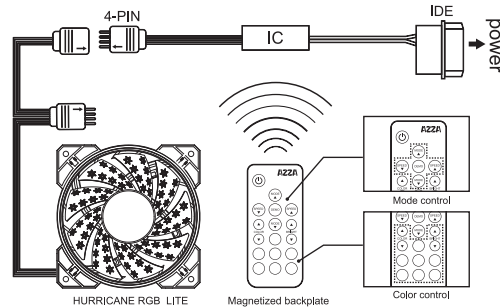

- The controller has a magnetized backplate, and can be attached to any metal surface. We do not suggest adhering it to hard drives.
- Please remove the tab from the battery compartment before use.

